



U. S. ROUTE 50
30' TO C/I/L

O.H. WIRES
S 86°29'00" E 300.00'

STONE WALL

4.8'

DRAINAGE DITCH

POND

8
146,351 S.F.
3.35976 ACRES

*
2 STY BRK/FRM
37072
(Posted)

To BE
Enclosed
with windows

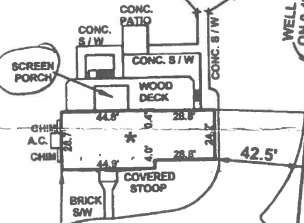

565.65'

N 10°11'42" E

19' VA. ELECTRIC POWER CO. ESMT. D TRANS.

S 18°42'38" W

OFF 1.1'

15' C. & P. TELE. CO. & VA. ELECT. POWER ESMTS.

A = 162.00'
R = 275.00'

N 87°28'50" W 48.00'

LOT 11
LOT 9

F.I.P.

ADAMS GREEN LANE
(50' Wide)

HOUSE LOCATION

LOT 8 SECTION TWO
MELMORE
LOUDOUN COUNTY, VIRGINIA

NOTES:
NO CORNER MARKERS SET PER WAIVER FROM CLIENT.

THE DWELLING SHOWN HEREON IS NOT LOCATED IN A SPECIAL FLOOD HAZARD AREA UNLESS OTHERWISE NOTED.

THIS IS NOT A BOUNDARY SURVEY AND IS NOT TO BE USED FOR CONSTRUCTION PURPOSES.

FENCES, IF SHOWN ARE APPROX. ONLY AND DO NOT CERTIFY AS TO OWNERSHIP.

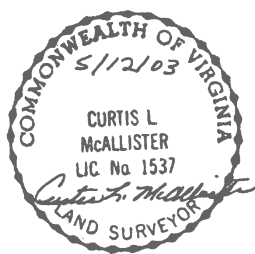

**HIGHLANDER SURVEYING SERVICES P.C.
CURTIS L. McALLISTER, L. S.**

I HEREBY CERTIFY THAT THE POSITIONS OF ALL THE EXISTING IMPROVEMENTS ON THE ABOVE DESCRIBED PROPERTY HAVE BEEN ESTABLISHED BY A TRANSIT TAPE SURVEY AND THAT UNLESS OTHERWISE SHOWN THERE ARE NO VISIBLE ENCROACHMENTS.

SCALE: 1" = 60'	DRAWN WED / cadd
DATE: May 12, 2003	CHECK CLM
NO TITLE REPORT FURNISHED	PHONE # 703-273-1619
D.B. 1779 PAGE 2367	WILHOITE / LISA